

Instrument of Grant

Section 63 of the *Mining Act 1992*

I, **Hamish Sinclair, Director Title Assessments**, as delegate of the Minister administering the *Mining Act 1992* for the State of New South Wales, pursuant to section 63 of the *Mining Act 1992*, have determined to grant a Mining Lease in satisfaction of **Mining Lease Application 570 (Act 1992)**, as described in Schedule 1, to **Walker Quarries Pty Ltd ACN 003 061 890**, subject to the conditions:

1. prescribed in the *Mining Act 1992* and the Mining Regulation 2016; and
2. set out in Schedule 2.



Hamish Sinclair
Director Title Assessments
Regional NSW – Mining, Exploration and Geoscience
As delegate for the Minister administering the *Mining Act 1992*
Delegation dated: 28 February 2023

Dated this 27th day of October 2023

SCHEDULE 1

Description of Lease

Mining lease number:	1865 (Act 1992)
Grant date:	27 October 2023
Term:	21 Years
Term ending (expiry date):	27 October 2044
Lease Holder(s)	Walker Quarries Pty Ltd, ACN 003 061 890
Area:	21.88 hectares
Surface Exception	Nil
Depth Restriction:	140 metres
Mineral(s):	Quartzite
Method:	Open Cutting
Land:	The lease area includes all land described in the attached lease plan titled M27627 and approved on 11 October 2023 .

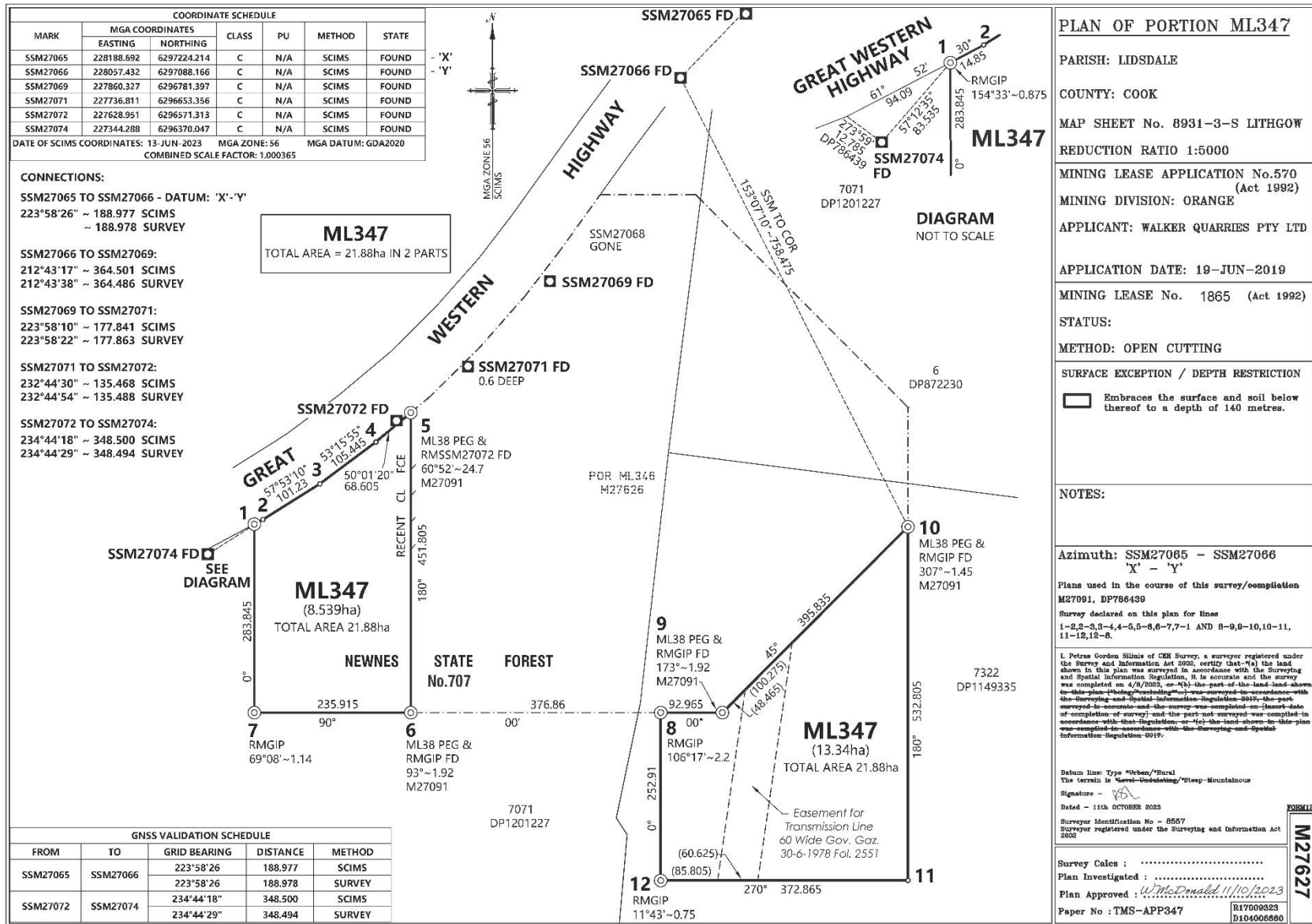

ADMINISTRATION SHEET

PLAN OF PORTION ML347

PARISH: LIDSDALE
 COUNTY: COOK
 MAP SHEET No. 8931-3-S LITHGOW
 REDUCTION RATIO 1:5000
 MINING LEASE APPLICATION No.570
 (Act 1992)
 MINING DIVISION: ORANGE
 APPLICANT: WALKER QUARRIES PTY LTD

APPLICATION DATE: 19-JUN-2019
 MINING LEASE No. 1865 (Act 1992)
 STATUS:
 METHOD: OPEN CUTTING

SURFACE EXCEPTION / DEPTH RESTRICTION
 Embraces the surface and soil below thereof to a depth of 140 metres.

NOTES:

Azimuth: SSM27065 - SSM27066
 'X' - 'Y'

Plans used in the course of this survey/completion
 M27091,DP786439

Survey declared on this plan for lines
 1-2,2-3,3-4,4-5,5-6,6-7,7-1 AND 8-9,9-10,10-11,
 11-12,12-8.

I, Petrus Gordon Skille of CEH Survey, a surveyor registered under the Survey and Information Act 2005, certify that: (a) the land shown in this plan was surveyed in accordance with the Surveying and Spatial Information Regulation, it is accurate and the survey was completed on 4/9/2023, or (b) the part of the land shown in this plan (being/including) was surveyed in accordance with the Surveying and Spatial Information Regulation 2017, the part surveyed is accurate and the survey was completed on (insert date of completion of survey) and the part not surveyed was compiled in accordance with the Regulation or (c) the land shown in this plan was compiled in accordance with the Surveying and Spatial Information Regulation 2017.

Return Base Type *Urban/Rural
 The terrain is *Level-Undulating/*Steep-Mountainous

Signature - *PS*

Dated - 11th OCTOBER 2023

Surveyor Identification No - 8557
 Surveyor registered under the Surveying and Information Act 2005

FORM 12
M27627

Survey Calcs :

Plan Investigated :

Plan Approved *W. McDonald 11/10/2023*

Paper No : TMS-APP347 R17000328
 D104006681

MGA2020 COORDINATES ZONE 56 ML347		
POINT	EASTING	NORTHING
1	227414.50	6296415.35
2	227427.60	6296422.35
3	227513.37	6296476.18
4	227597.91	6296539.28
5	227650.50	6296583.37
6	227650.50	6296131.40
7	227414.50	6296131.40
8	228027.49	6296131.40
9	228120.49	6296131.40
10	228400.49	6296411.40
11	228400.49	6295878.40
12	228027.49	6295878.40

BOUNDARY COORDINATES DETERMINED
 DATE: 4-8-2023

MGA ORIGIN POINT: SSM 27066

SCHEDULE 2

Mining Lease Conditions 2021

(Version 1.1 as at February 2022)

Definitions

Words used in this mining lease have the same meaning as defined in the *Mining Act 1992* except where otherwise defined below:

Term	Definition
Act	means the <i>Mining Act 1992</i> .
Landholder	for the purposes of these conditions: <ul style="list-style-type: none">• does not include a secondary landholder• includes, in the case of exempted areas, the controlling body for the exempted area.
Minister	means the Minister administering the Act.

Note:

1. The rights and duties of the lease holder(s) are those prescribed by the *Mining Act 1992* and the Mining Regulation 2016, subject to the terms and conditions of this mining lease.
2. This mining lease does not override any obligation on the lease holder(s) to comply with the requirements of other legislation and regulatory instruments which may apply (including all relevant development approvals) unless specifically provided under the *Mining Act 1992* or other legislation or regulatory instruments.

Mining Lease Conditions 2021	Version Date: February 2022 (Version 1.1)
Mining Lease 1865 (Act 1992)	Page 5 of 7

MINING LEASE CONDITIONS

Standard conditions

See Mining Regulation 2016, Schedule 8A, Part 2.

NOTE TO HOLDERS: The prescribed standard conditions in the Mining Regulation 2016, Schedule 8A, Part 2 apply in addition to the conditions in this Schedule 2 (but have not been replicated in this mining lease). The conditions imposed by the Mining Regulation 2016 prevail to the extent of any inconsistency with the conditions in this Schedule 2.

General conditions

1. Notice to Landholders

(a) Within 90 days from the date of grant or renewal of this mining lease, the lease holder must give each landholder notice in writing:

- (i) that this mining lease has been granted or renewed; and
- (ii) whether the lease includes the surface.

The notice must include a plan identifying the lease area and each landholder and individual land parcel within the lease area.

(b) If there are ten or more landholders to which notice must be given, the lease holder will be taken to have complied with condition 1(a) if a notice complying with condition 1(a) is published in a newspaper circulating in the region where the lease area is situated.

2. Security

The lease holder is required to provide and maintain a security deposit to secure funding for the fulfilment of obligations under the mining lease, including obligations under the mining lease that may arise in the future.

The amount of the security deposit to be provided and maintained is **\$10,000**.

3. Cooperation Agreement

The lease holder must make every reasonable attempt, and be able to demonstrate its attempts to the satisfaction of the Secretary, to enter into a cooperation agreement with the holder(s) of any overlapping authorisations issued under the *Mining Act 1992* and petroleum titles issued under the *Petroleum (Onshore) Act 1991*. The cooperation agreement should address but not be limited to:

- access arrangements
- operational interaction procedures
- dispute resolution

Mining Lease Conditions 2021	Version Date: February 2022 (Version 1.1)
Mining Lease 1865 (Act 1992)	Page 6 of 7

- information exchange
- well location
- timing of drilling
- potential resource extraction conflicts; and
- rehabilitation issues.

4. Assessable Prospecting Operations

- (a) The lease holder must not carry out any assessable prospecting operation on land over which this lease has been granted unless:
- (i) it is carried out in accordance with any necessary development consent; or
 - (ii) if development consent is not required, the prior written approval of the Minister has been obtained.
- (b) The Minister may require the lease holder to provide such information as required to assist the Minister to consider an application for approval.
- (c) An approval granted by the Minister under this condition may be granted subject to terms.
- (d) The lease holder must comply with the approval granted to the holder under this condition.

Special conditions

Nil

Exploration Reporting

Note: Exploration Reports (Geological and Geophysical)

The lease holder must lodge reports in accordance with the requirements in section 163C of the Mining Act 1992 and clauses 59, 60 and 61 of the Mining Regulation 2016 as well as any further requirements issued by the Secretary under clause 62 of the Mining Regulation.

Guidelines for the structure, content and data format requirements for reports are set out in the Exploration Reporting: A guide for reporting on exploration and prospecting in New South Wales.

Mining Lease Conditions 2021	Version Date: February 2022 (Version 1.1)
Mining Lease 1865 (Act 1992)	Page 7 of 7